

User Manual
用户手册

Slypod Remote Controller

MOZA Slypod Remote Controller

Remote Controller

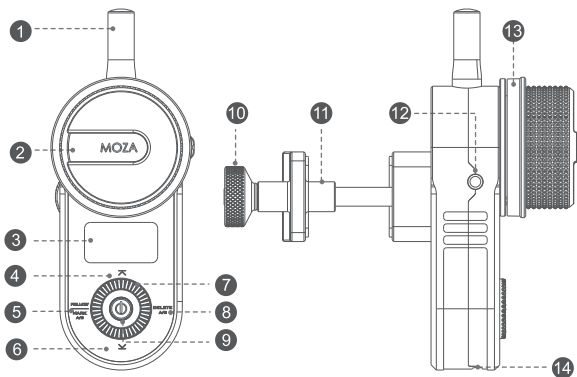

- | | | |
|------------------------|------------------------|---------------------|
| 1 Antenna | 6 Down Button | 11 Support Rod Clip |
| 2 Wheel | 7 Dial | 12 Multi-CAN Port |
| 3 OLED Display Screen | 8 DEL / Shutter Button | 13 Mark Ring |
| 4 Up Button | 9 Power Button | 14 USB Port |
| 5 Mark / Follow Button | 10 Knob Screw | |

Status Display

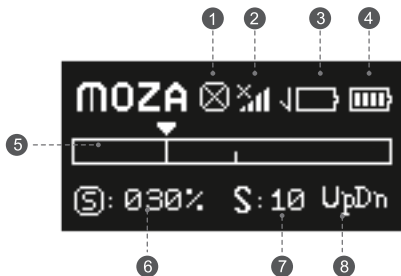

- | | | | |
|---|---------------------------------|---|-----------------|
| 1 | Route Calibration Status | 5 | Route Bar |
| 2 | Wireless Connection Status | 6 | Moving Position |
| 3 | Slypod Battery Level | 7 | Moving Speed |
| 4 | Remote Controller Battery Level | 8 | Modes Display |

Connecting to the Slypod

Pairing

- Turn off the Slypod
- Turn on the remote controller, enter the menu interface, and select Wireless>Pair>Pairing
- Press the power button of Slypod, after the light ring flashes, the controller screen will display "Pair OK!". Keep holding the power button until the Slypod is turned on, the pairing is complete."

⚠ Note: After the pairing is completed, please start the route calibration on the remote controller before controlling the Slypod. Please refer to page 11.

Modes Operations

UP/DOWN Mode

Long press the top button to enter the UP mode, the Slypod extends; the Slypod will stop extending when releasing the button. Rotate the dial to adjust the extending speed while in motion. Turn the dial clockwise to increase the speed; turn the dial counterclockwise to decrease the speed.

Long press the down button to enter the DOWN mode, the Slypod retracts; the Slypod will stop retracting when releasing the button. Rotate the dial to adjust the retracting speed (while retracting). Turn the dial clockwise to increase the speed; turn the dial counterclockwise to decrease the speed.

Getting Started

Installation

- Loosen the knob screw on the rod clip.
- Attach the support rod into the clip.
- Tighten the knob screw.

▲ Note: the diameter range of the support rod should be 15mm to 32mm.

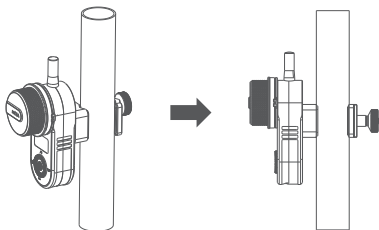

Charging

Connect the remote controller to the charger via a USB-C cable, then the charging and battery level icon will be displayed on the screen. After the battery is fully charged, the icon will disappear.

Buttons Operations

Interface	Operations	Up Button	Down Button	Mark / Follow Button	DEL / Shutter Button	Power Button
Main interface	1 × click	UP mode	Down mode	Follow mode	Take photo	Enter menu
	2 × click	TOP mode	BTM mode	—	—	—
	Press for 3s	Move up	Move down	Mark A,B point	Delete A,B point	Power off
Menu	1 × click	Option-up	Option-down	Return	Enter the next menu	Confirm

▲ Note: The right button (DEL/Shutter button) is used to control the camera when connected to the Slypod via a camera control cable to take photos. (Control cable optional for purchase)

Power On/Off

Turn On: Press the power button for 3 seconds until the MOZA icon appears on the screen. Turn Off: Press the power button for 3 seconds in power-on state.

⚠ Note: To switch from other modes to UP/DOWN mode, please press the up/down button in the menu interface.

TOP/BTM Mode

Double press the top button to enter TOP Mode. Use the remote controller to control the Slypod to extend continuously. Turn the dial to adjust the speed of movement.

Turn the dial clockwise to increase the speed. Turn the dial counter-clockwise to reduce the speed.

Double press the down button to enter BTM Mode. Use the remote controller to control the Slypod to retract continuously. Turn the dial to adjust the speed of movement.

Turn the dial wheel clockwise to increase the speed. Turn the dial counter-clockwise to reduce the speed.

FOLLOW Mode

Press the left button to enter the FOLLOW mode, rotate the wheel, and Slypod will follow the handwheel to relative position.

Rotate the wheel clockwise to control Slypod to extend in real time; rotate the wheel counterclockwise to control Slypod to retract in real time.

MARK Mode

In FOLLOW mode, set the A-B endpoint as shown in the picture, and Slypod will move within the range of the route marked by the remote controller.

Set the A-B Endpoints

- Control the remote controller to move to the endpoint A with the wheel;
- Press the MARK button until "A" appears on the route bar, then turn the wheel to move the remote controller to the endpoint B;
- Release the MARK button to complete the A-B endpoints setting.

Cancel the A-B Endpoints

With the white A-B endpoints bar displayed on the screen, long press the DEL button to cancel the A-B endpoints.



AUTO Mode

Press the power button to enter the menu, right click to select Motor> to enter the AUTO mode, the movement direction and speed of the Slypod can be set through the remote controller.

Dir	:	UP
Range	:	25
Time	[1s]
Run	Run	

Menu Introduction

Motor>: AUTO Mode Settings

Dir: set the movement direction of the Slypod through the remote controller, press the power button to switch direction.

Range: set the movement length of the Slypod through the remote controller, turn the dial to adjust the length value. (Total length is 280mm)

Time: set the movement time of the Slypod through the remote controller, turn the dial to adjust the movement time. (Maximum setting time is 2000s, long press the right button of the dial to increase the route time quickly)

Run: press the power button to start or stop moving.

Function > Wheel Calibrate>

The remote controller controls the movement of Slypod through the wheel. Under normal circumstance, the value is the smallest when turning the wheel counter-clockwise to the endpoint, and the value gets the largest when turning the wheel clockwise. If the wheel is abnormal, calibration is required.

Wheel Calibrate >
Brightness : 050

- a. Turn the wheel to the starting position, and click the right button of the dial to confirm.

1. Turn to the starting position;
Click [>] to confirm.

- b. Turn the wheel to the end position, and click the right button of the dial to confirm;

2. Turn to the end position; Click [>] to confirm.

- c. Click the left button to stop the calibration, or click the power button to return to the main interface.

Brightness>: Brightness Adjustment Screen

After Brightness is selected, turn the dial to adjust its value from 0 to 100. The higher the value, the higher the brightness of the screen.

About >:

Display the firmware version information of the remote controller.

Firmware Upgrade

The remote control can be upgraded independently. Operation steps:

- Turn off the remote controller;
- Connect the remote controller to computer with Type-C cable.
- Long press the up button and don't release, click the power button. "Boot Mode" will pop up on the screen, the controller enters the upgrade mode.
- Open the MOZA Master software. Click the corresponding device in the device list to enter the upgrade interface.
- MOZA Master software will automatically download the latest version of firmware when connected to the Internet. After the firmware download is complete, click the "Upgrade" button.
- Do not operate the remote controller during the firmware upgrade.
- Restart the remote controller after firmware upgrade.

⚠ Please download the MOZA Master (1.2.0 version or above) software from Gudsen MOZA official website to upgrade. Please install related drivers before running the MOZA Master software, for specific operations, please contact the MOZA after-sale service or refer to the relevant tutorial documents on the official website.

SPECS

Weight	208g
Dimension	38*92*48mm
Working Voltage	3.7V
Battery Capacity	750mAh
Upgrade / Charging Port	USB-C
Working Temperature	0-50°C

认识MOZA Slypod 遥控器

遥控器

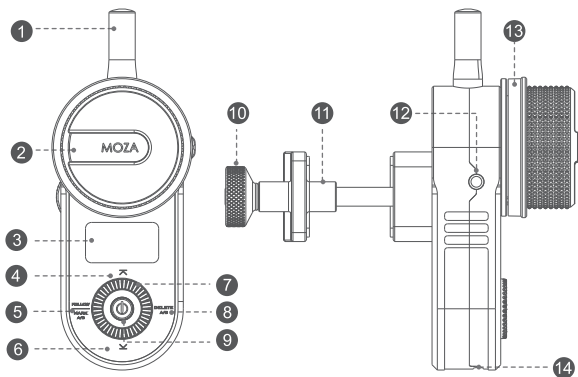

1 天线

2 手轮

3 OLED显示屏

4 UP键

5 MAKE键/FOLLOW键

6 DOWN键

7 拨盘

8 DEL键/拍照键

9 开关键

10 管夹锁紧螺丝

11 管夹

12 Multi-CAN接口

13 标记环

14 USB-C接口

入门

安装

- 将管夹锁紧螺丝拧松；
- 将管夹套入安装遥控器的圆管上；
- 拧紧管夹锁紧螺丝。

⚠ 注意：遥控器的管夹能夹持在直径为15mm到32mm的圆管上。

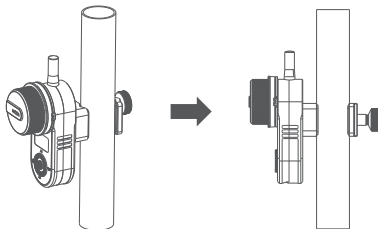

充电

使用USB-C线将遥控器连接到充电器，遥控器的显示屏会显示充电图标和电量，电池充满后，充电图标消失。

按键功能定义

界面	操作	上(UP)	下(DOWN)	左 (FOLLOW)	右 (DEL)	电源
主界面	单击	UpDn模式	UpDn模式	FOLLOW模式	拍照	进入菜单
	双击	TOP模式	BTM模式	—	—	—
	长按3s	向上运动	向下运动	标记A,B点	删除A, B点	关机
菜单	单击	选择条上移	选择条下移	返回	进入下一级	确认

⚠ 注意：遥控器右键可控制使用相机控制线与Slypod连接的相机拍照。（相机控制线需另购）

开机、关机

长按电源键3秒，屏幕上显示MOZA图标则开机成功。开机状态下，长按电源键3秒即关机

状态显示

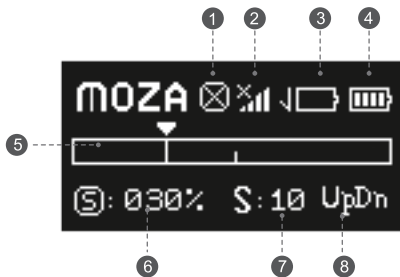

- | | |
|----------|----------|
| ① 行程校准状态 | ⑤ 行程显示条 |
| ② 无线连接状态 | ⑥ 运动位置显示 |
| ③ 伸缩杆电量 | ⑦ 运动速度显示 |
| ④ 遥控器电量 | ⑧ 模式显示 |

连接Slypod

配对

- 保证Slypod处于关闭状态；
- 打开遥控器，进入菜单，选择Wireless>Pair>Pairing；
- 按下Slypod开机键，Slypod上电（灯环闪烁）后，遥控器屏幕会显示“Pair OK!”，保持Slypod开机键按住直至魔杖完成开机后，配对完成。

▲ 注意：配对成功后，需要先进行遥控器的行程校准，才能正常控制Slypod。参考第11页

操作教程

手动模式

长按上键，进入UP模式，遥控器控制Slypod向上运动；松开按键，Slypod停止向上运动。旋转拨盘调节运动速度。顺时针旋转拨轮，速度增加；逆时针旋转拨轮，速度减小。长按下键，进入DOWN模式，遥控器控制Slypod向下运动；松开按键，Slypod停止向下运动。旋转拨盘实时调节运动速度。顺时针旋转拨轮，速度增加；逆时针旋转拨轮，速度减小。

▲ 注意：从其他模式切换到手动模式时，需要单击菜单上键/下键进入UpDn模式

TOP/BTM模式

双击上键，进入TOP模式，遥控器控制Slypod持续向上运动，旋转拨盘调节运动速度。顺时针旋转拨轮，速度增加；逆时针 旋转拨轮，速度减小。

双击下键，进入BTM模式，遥控器控制Slypod持续向下运动，旋转拨盘调节运动速度。顺时针旋转拨轮，速度增加；逆时针 旋转拨轮，速度减小。

FOLLOW模式

单击左键进入FOLLOW模式，转动遥控器手轮，Slypod则跟随手轮转动的行程位置运动到相对的行程位置。

顺时针旋转遥控器手轮，实时控制Slypod伸出；逆时针旋转遥控器手轮，实时控制Slypod缩回。

MARK模式

在已经进入FOLLOW模式下,如图设置A-B限位，Slypod则在遥控器标记限位的行程范围内运动。

设置A-B限位

- 用手轮控制遥控器标记点运动到限位A；
- 按住MARK键，当行程显示条出现A字样时，转动手轮控制遥控器标记点运动到限位B；
- 松开MARK键，A-B限位设置完成。

取消A-B限位

在屏幕上显示有白色A-B限位条的状态下，长按DEL键，可取消设置的A-B限位，恢复行程校准的限位。



AUTO模式

a. 单击电源键进入菜单，右键选择Motor>进入auto模式，即可自行设置遥控器控制Slypod运动的方向与速度。

Dir	:	UP
Range	:	25
Time	[1s]
Run		Run

菜单介绍

Motor> : Auto模式设置

Dir : 设置遥控器控制Slypod运动的方向，单击电源键切换运动方向。

Range : 设置遥控器控制Slypod运动行程长度，旋转拨盘调节运动行程长度。(总行程280mm)

Time：设置遥控器控制Slypod行程运动的时间，旋转拨盘调节行程运动时间(最大设置时间2000s，长按拨盘右键快速增加行程时间)

Run：单击电源键切换开始行程运动/停止运动

Function > Wheel Calibrate>：手轮校准

遥控器使用手轮控制Slypod运动。正常情况下，手轮逆时针旋转到限位时数值最小，手轮顺时针旋转到限位时数值最大。如手轮异常，则需要进行手轮校准。

点击右键开始操作

Wheel Calibrate >
Brightness : 050

a. 将手轮转动到起始位置（如图），点击拨盘右键确认；

1.Turn to the starting position;
Click [>] to confirm.

b. 将手轮转动到结束位置（如图），点击拨盘右键确认；

2.Turn to the end position;Click [>] to confirm.

c. 点击拨盘左键退出校准，或者点击菜单键回到主界面。

Brightness>：屏幕显示亮度调节

选中Brightness后，转动拨盘，可以从0到100调节其数值，数值越大，屏幕亮度越高。

About>：关于

查看遥控器固件版本信息。

固件升级

Slypod遥控器可以自己单独升级，升级操作如下：

- 将遥控器关机；
- 使用Type-C连接遥控器和电脑；
- 长按上键，不要松开，然后单击电源键，屏幕上会显示‘Boot Mode’，即进入固件升级状态；
- 在电脑中启动MOZA Master 软件，点击设备列表中对应的设备名称进入升级界面。

- e. 电脑在联网的情况下自动下载最新版本的固件。等待固件下载完成后，点击“升级”按钮。
- f. 升级过程中，请勿操作遥控器
- g. 重启遥控器即可

▲ 注意：请从MOZA官方网站下载MOZA Master（1.2.0或以上版本）软件进行升级。MOZA Master 软件运行前需要安装相关驱动，具体操作请咨询魔爪售后或参考官网相关教程文档。

规格参数

重量	208g
尺寸	38*92*48mm
工作电压	3.7V
电池容量	750mAh
升级/充电接口	USB-C
工作温度	0-50℃

产品保修卡

用户资料

产品型号	MOZA Slypod 遥控器
购买日期	
姓 名	
电 话	
地 址	

产品保修条例

保修期

自购机日起，遥控器主体保修12个月；电机、电池保修3个月。设备外壳、说明书、线材、包装等不在“一年免费保修服务”范围内，您可以选择有偿服务。

七日内免费退货

自购机日起7日内，根据国家最新三包规定，您可以选择退货（按票面金额一次性退清货款）、换货（更换同型号同规格的产品）或修理。

八至十五日免费换货或修理

自购机日起第8日至第15日内，主机出现性能故障，并经特约维修中心检测，确认非人为损坏的本身质量问题，您可以选择换货（更换同型号、同规格产品）或修理；但是更换的范围，只限于产品主机，其他配件无质量问题，不能更换；购买者在以下条件下不享受免费保修服务，您可以选择有偿服务。

1. 超过三包有效期的
2. 无三包凭证及有效发货票的，但能够证明该产品在三包有效期内的除外
3. 包修凭证上的型号与修理产品型号不符或者涂改的
4. 非本公司特约维修人员拆动造成损坏的
5. 因不可抗力造成损坏的
6. 未按产品使用说明书要求使用、维护、保养而造成损坏的

合格证

出厂日期: _____

质检员: _____

GUDSEN

INVENTED FOR VIDEO
Gudsen Technology Co., Ltd
Web: www.gudsen.com